

LASHING POINTS FOR CARS

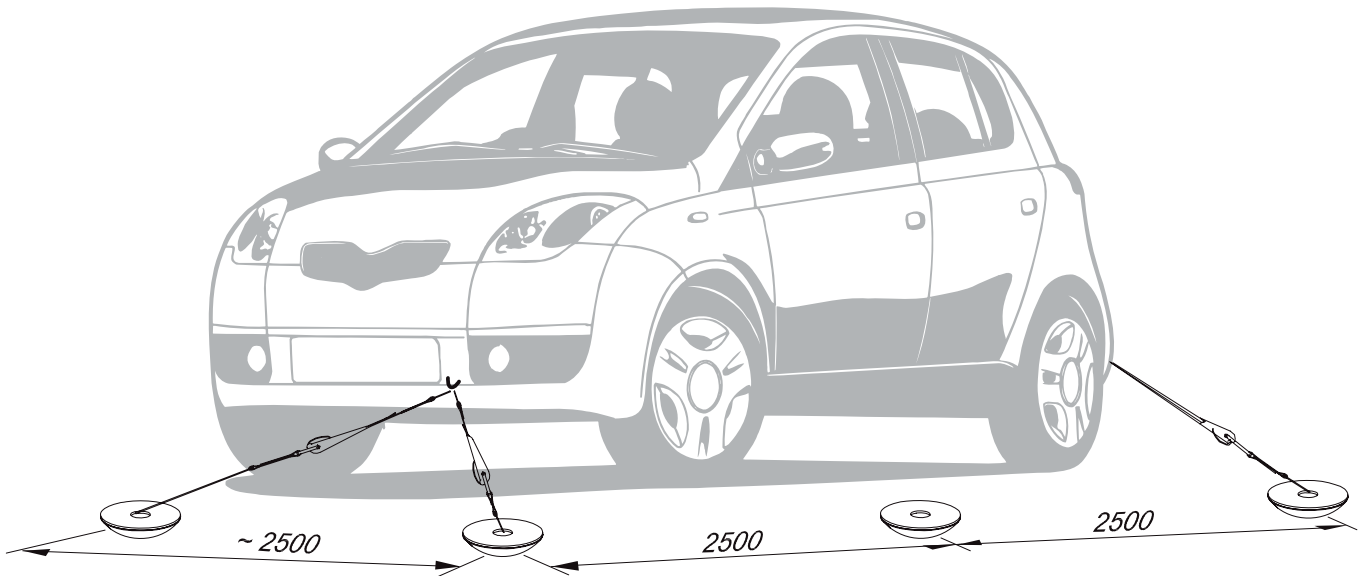

Flush Lashpoints

LP-H-F/PL196x6/CUP196x6/III

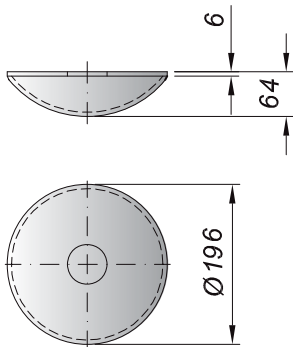

- Variation of chamfer upon request;
please compare to chapter 4.4

Options and variations for flush lashpoints

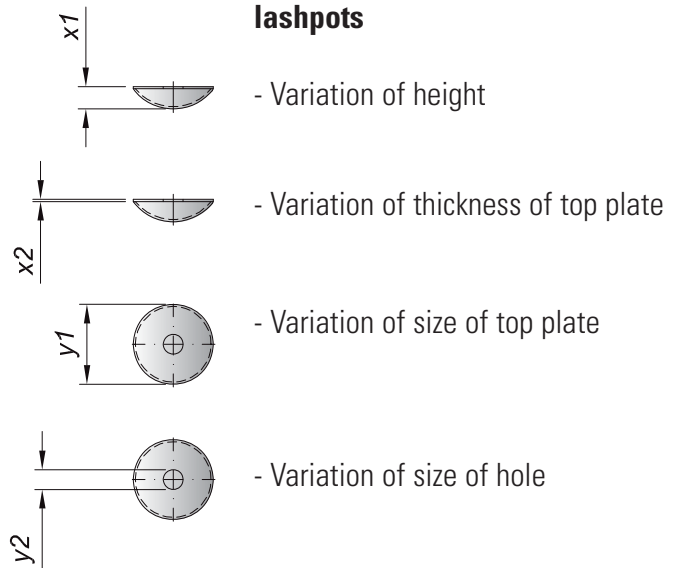

Specification

- Min. breaking load tension 60 kN
- Approval from any classification society
- Standard height 64 mm
- Thickness of top plating 6 mm
- Weldable inorganic zinc or epoxy shop primer
- Made of high tensile steel
- Counter part is hook

LASHING POINTS FOR CARS

Crinkle Bar
LAF-CB/2

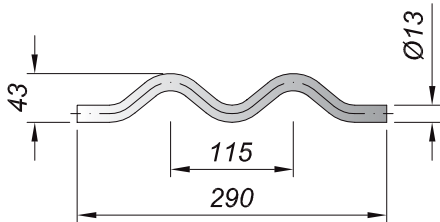

Welding recommendation

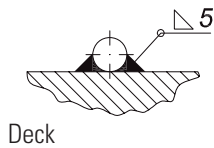

Baby Elephant Foot
LP-H-R/150x8/PM

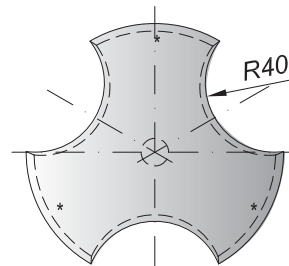
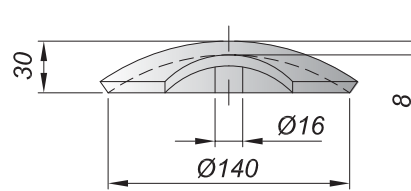

Welding recommendation

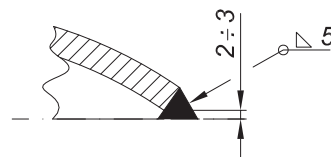

Specification

- Min. breaking load tension 2 x 30 kN for crinkle bar resp. 100 kN for baby elephant foot
- Approval from any classification society
- Weldable inorganic zinc or epoxy shop primer
- Made of high tensile steel
- Counter parts are car lashing units with hook end

LASHING POINTS FOR CARS

D-Rings

DR-1/15

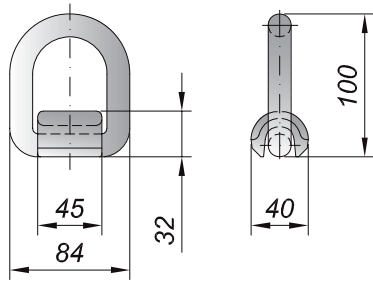

DR-2/15

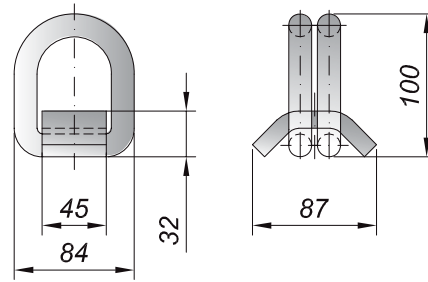

Welding recommendation

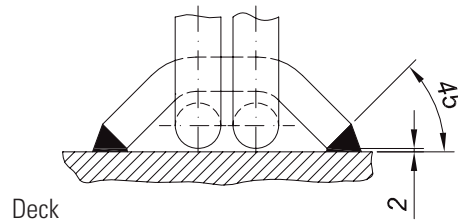
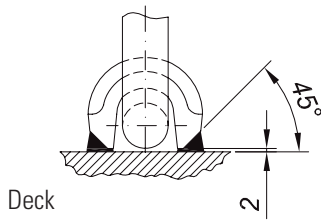

Specification

- Min. breaking load tension 150 kN
- Approval from any classification society
- Welding chamfer
- Drop forged D-ring and welding bow
- Made of high tensile steel
- Weldable inorganic zinc or epoxy shop primer
- Counter parts are turnbuckle, hook, shackle or car lashing