

MASTER LASHING (SINGLE WINCH SYSTEM)

Professional securing system for timber deck cargoes

(in compliance with IMO 275E "Code of Safe Practice for Ships Carrying Timber Deck Cargoes")

Lashing arrangement for unitized/packaged timber

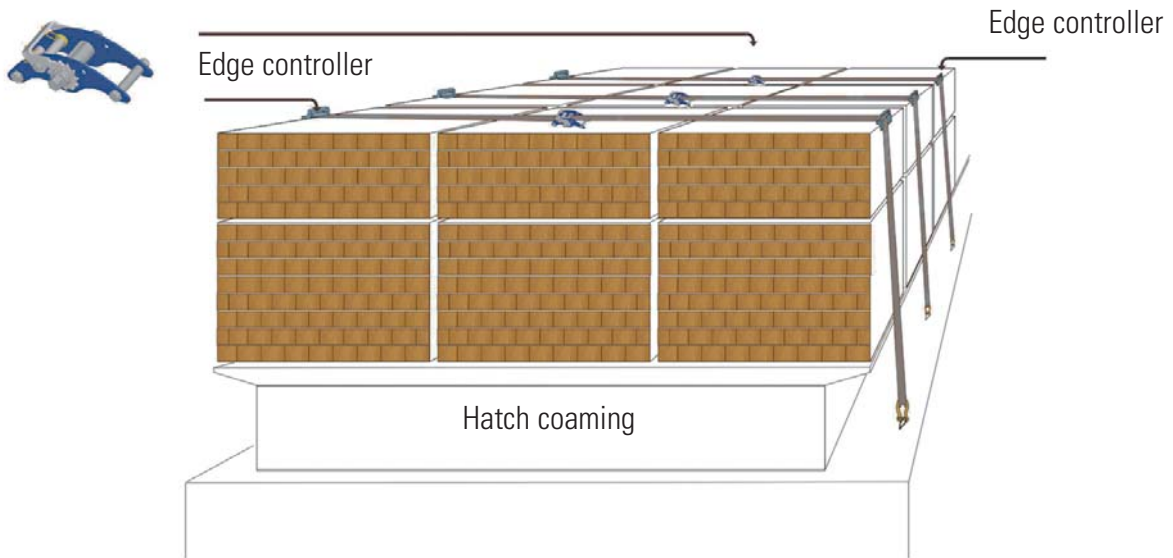

Lashing arrangement for Logs

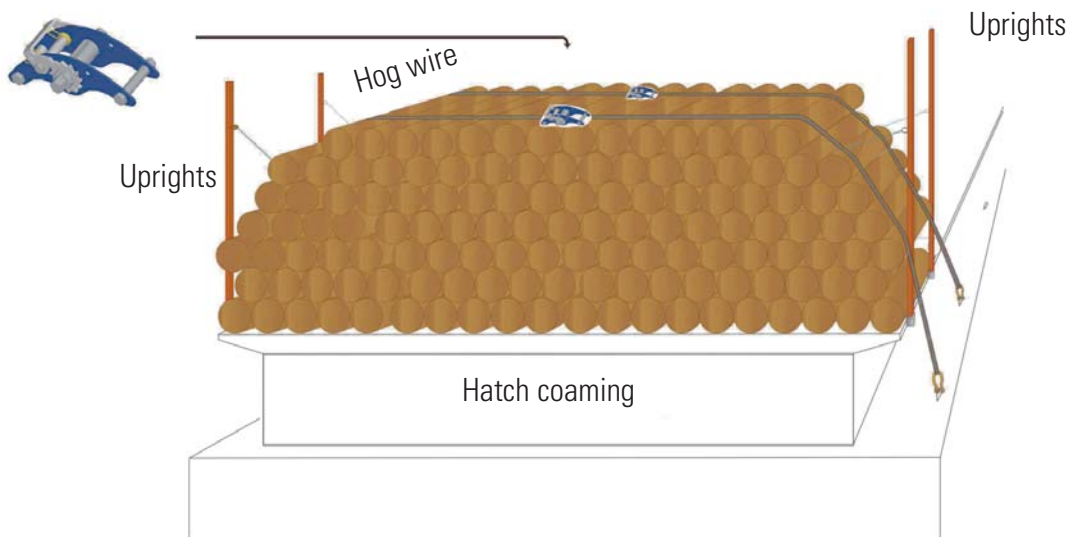

MASTER LASHING (SINGLE WINCH SYSTEM)

Master Lashing

ML-1/100/13.3

Single winch arrangement



Fixed fittings

DR-50

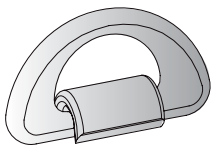

see chapter 3.13

LAP-1

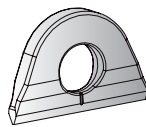

see chapter 3.9

Components of each system

- 1 x Ratchet Winch
- 1 x Web band 100 % PES, fixed end / 1 reinforced eye / 1 soft eye
- 1 x Web band 100 % PES, loose end / 1 reinforced eye / 1 open end
- 2 x shackles
- 2 x Edge controller (web band protector) – Option

Benefits

- Easy handling and quick installation
- Easy access to tightening devices (ratchet winch) via cargo topside
- Additional personnel protection + safety devices required
- Tailor-made system to match vessel's specifications, tie down provisions and cargo dimensions

Specification

- Min. breaking load tension 13300 daN
- Extremely high tensile band webbing (100 % Polyester)
- Gasoline-, lubricant- and solvent-proof
- High quality steel ratchet winch, galvanization of all parts
- Safe-release feature (stand-off operation)