

ELONGATED FOUNDATIONS

Sliding range ± 10

SF-1/144/110/U160x180

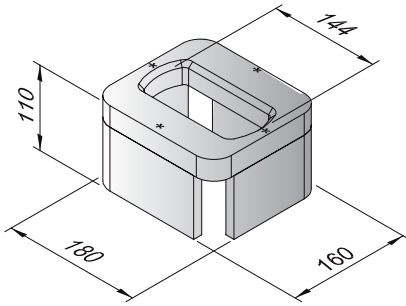

Sliding range ± 30

SF-1/184/110/U160x220

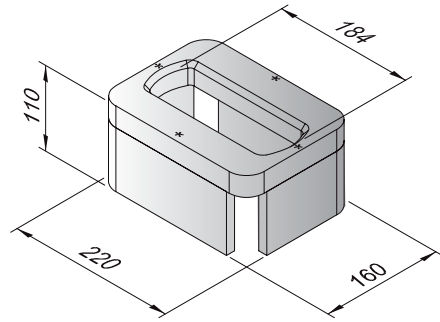

Sliding range ± 50

SF-1/224/110/U160x260

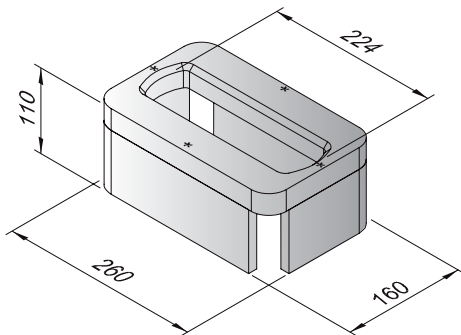

Welding recommendation

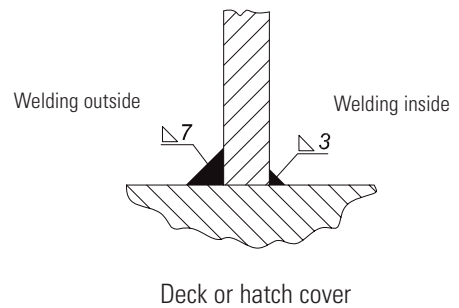

Specification

- Min. breaking loads tension 500kN / shear 420 kN
- Approval from any classification society
- Standard height 110 mm
- Topplate with punchmarks for easy installation
- Standard distances for double foundations 203/216/258 mm
- Weldable inorganic zinc or epoxy shop primer
- Made of high tensile steel
- Special sliding range on request
- Other options and variations please compare with raised foundations
- As a standard we offer elongated foundations with hardened topplates (min. 235 HB) in order to reduce wear down

ELONGATED FOUNDATIONS

Double foundations with combined box structure

Sliding range ± 10

203	363
SF-2/ 216 /124-144/110/U	376 x180
258	418

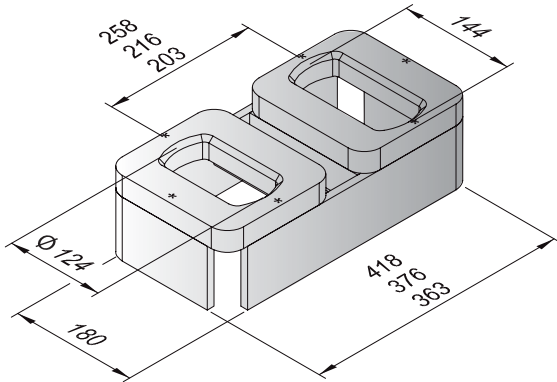

203	363
SF-2/ 216 /144-144/110/U	376 x180
258	418

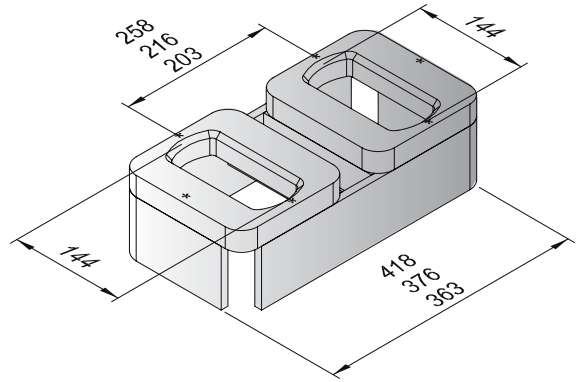

Sliding range ± 30

203	363
SF-2/ 216 /124-184/110/U	376 x220
258	418

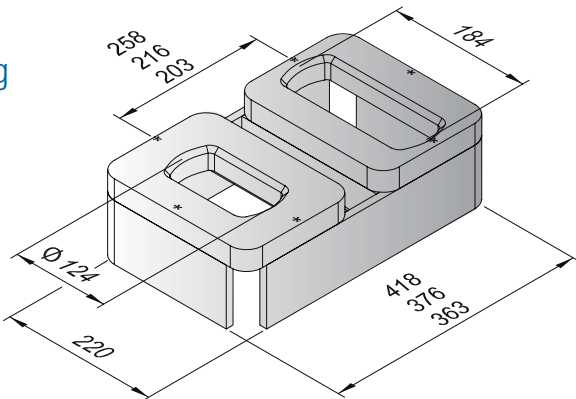

203	363
SF-2/ 216 /184-184/110/U	376 x220
258	418

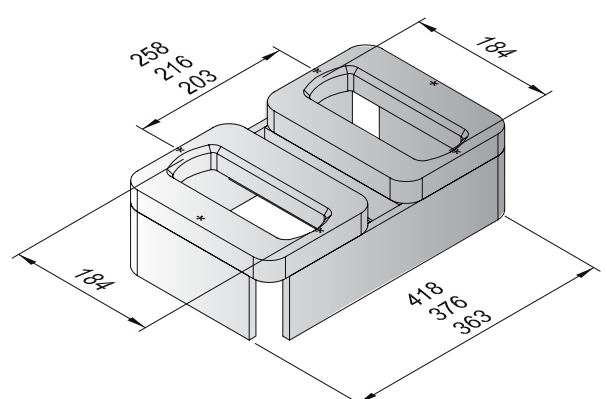

Sliding range ± 50

203	363
SF-2/ 216 /124-224/110/U	376 x260
258	418

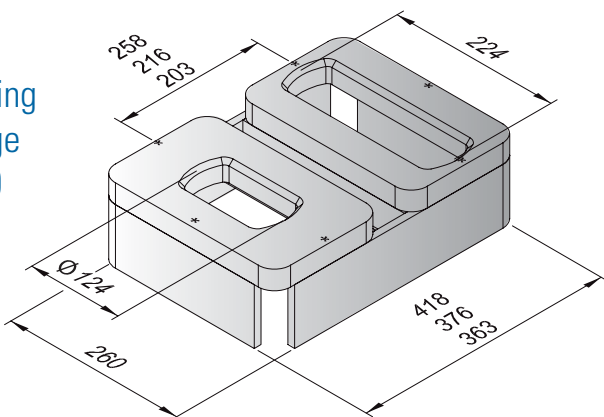

203	363
SF-2/ 216 /224-224/110/U	376 x260
258	418

