

LASHING PLATES

LAP-1

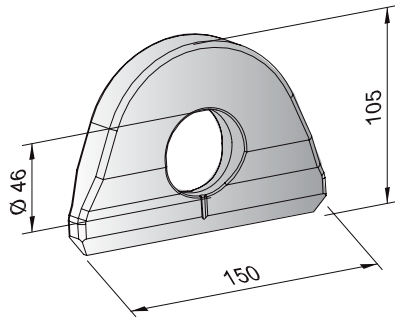

LAP-2/100

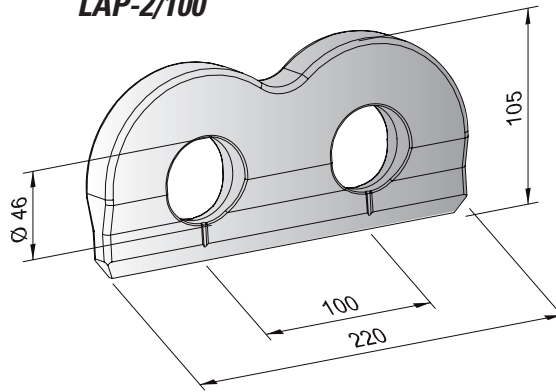

Welding recommendation

The angle α depends on the distance between the lashing plate and the container front.

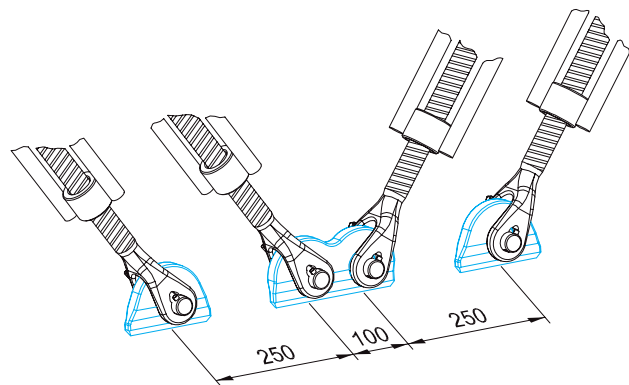
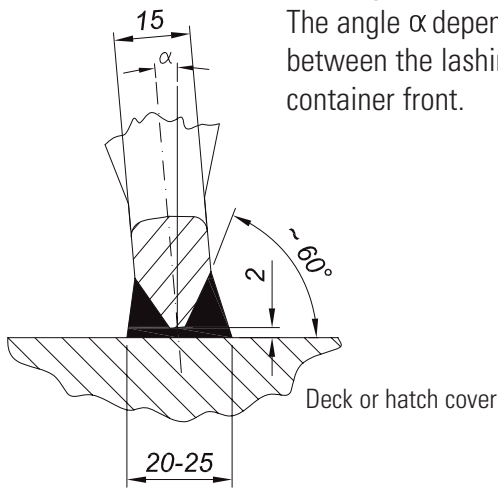

Typical arrangement of lashing plates for double cross lashing systems

Specification

- Min. breaking load 500 kN
- Approval from any classification society
- Welding chamfer
- Drop forged execution
- Made of high tensile steel
- Weldable inorganic zinc or epoxy shop primer
- Smoothed edges all around
- Centre marking for easy installation