

HATCH COVER LIFTING STOPPER



SF-1HSL/160/110/±45



TL-A/HS
~ 7.7 kg

> Application <

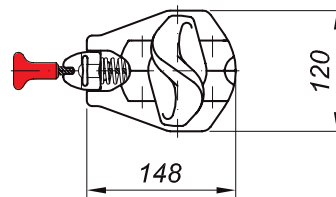
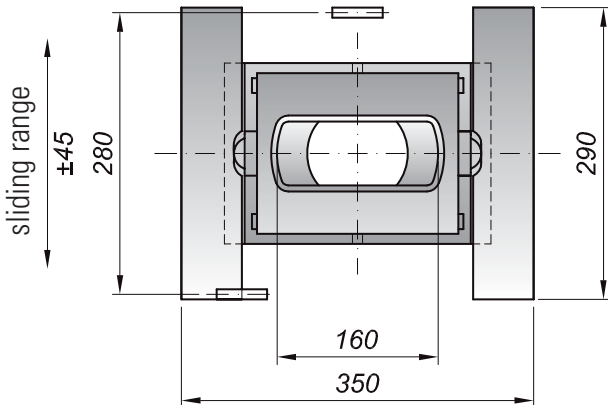
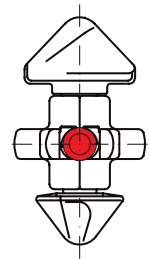
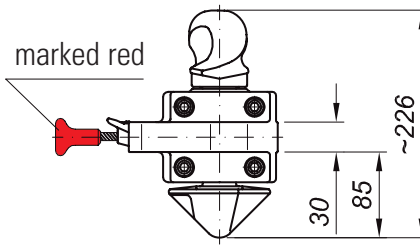
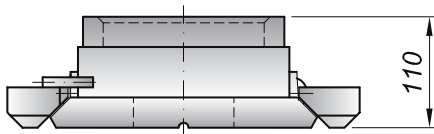
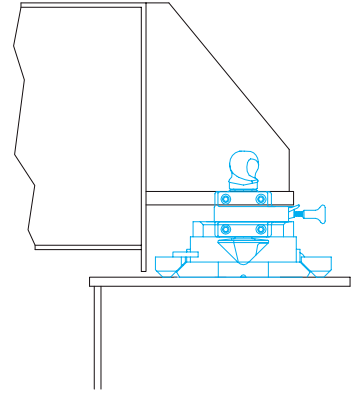

PATENTED

Specification

- Min. breaking load tension 800 kN
- Approval from any classification society
- Automatic locking of twistlock when closing panels
- The sliding part of foundation always remains in neutral position due to spring loaded ball pen solution
- Fully forged twistlock in hot dip galvanised execution with stainless steel components
- The foundation can be made to measure according to the individual situation on board as far as necessary sliding range, height, steel grade of conic wedges and surface treatment is concerned